

How to Login and View CCTV (Mobile Application)

1.0 Application Installation

1.

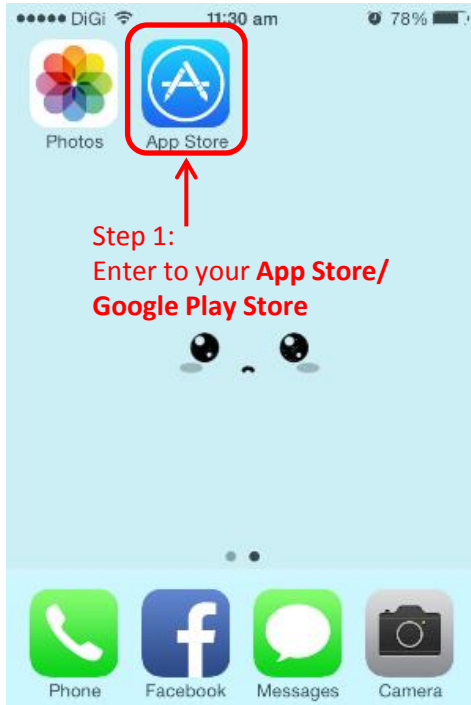

2.



3.

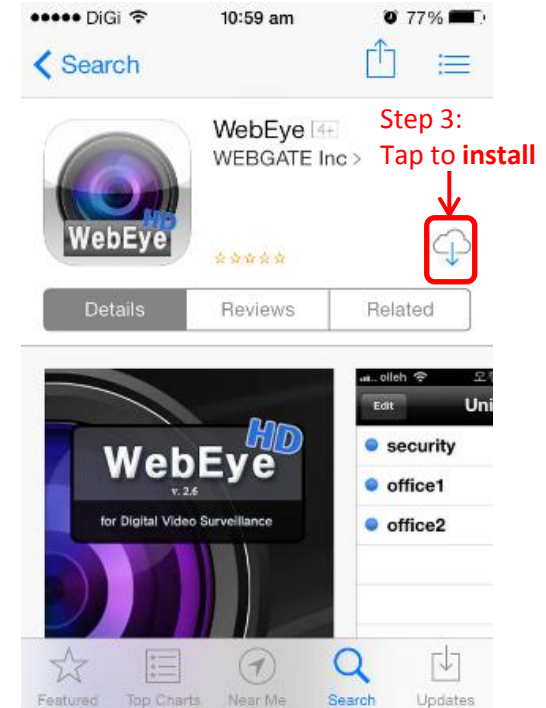

How to Login and View CCTV (Mobile Application)

1.1 Add New Entry

1.

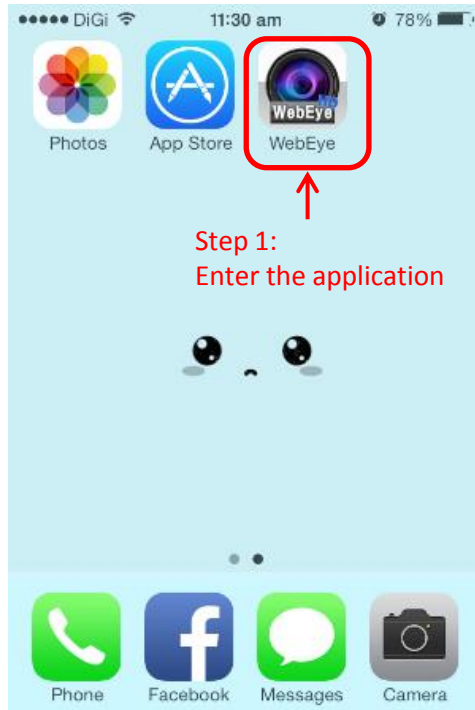

2.

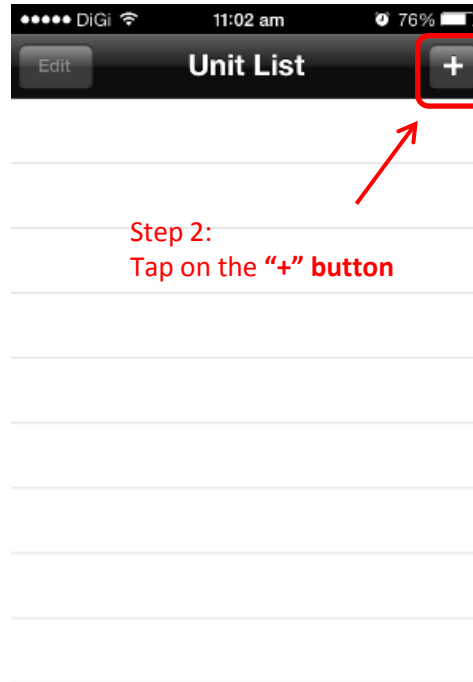

3.

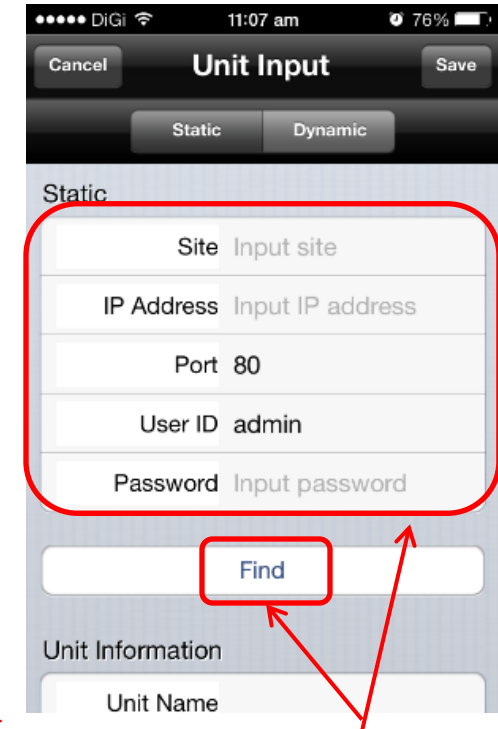

Step 3:

Enter your

- a.) Site : Your nursery's site name
- b.) IP Address : Your nursery's external IP address
- c.) Port : Your nursery's port
- d.) User ID : admin
- d.) Password : Your nursery's DVR password

Then tap the "Find" button